

LRB-C Rubber Mounts

LIVA-EP
利瓦环保

Feature:

- ★Reduction of structure-borne noise.
- ★Reduction of vibration from rotating or reciprocating machinery
- ★Sturdy, reliable construction.
- ★Reduce effects of misalignment and distortion.
- ★Available in a wide load range.
- ★Low cost.
- ★Prevent shock and vibration damage to sensitive equipment.
- ★Resist oil, ozone and caustic materials.

Applications:

HVAC equipment、Relays and control panels、Pumps and Compressors、Machinery

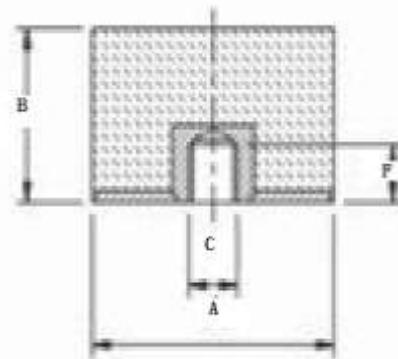

Type	Dimensions (mm)			Capacity KG		Optimum reduction mm
	A	B	C	40°	60°	
LRB-C08*08	8	8	M3	4	8	1.5
LRB-C10*08	10	10	M3/M4	5	10	1.5
LRB-C10*10	10	10	M3/M4	5	10	2
LRB-C10*15	10	15	M3/M4	5	10	2
LRB-C15*10	15	10	M4/M5	10	18	2
LRB-C15*15	15	15	M4/M5	10	18	2
LRB-C15*20	15	20	M4/M5	10	18	2
LRB-C15*30	15	30	M4/M5	10	18	2
LRB-C20*10	20	10	M6	10	20	1.5
LRB-C20*15	20	15	M6	13	25	2
LRB-C20*20	20	20	M6	13	25	2
LRB-C20*25	20	25	M6	15	28	2
LRB-C20*30	20	30	M6	22	35	2.5
LRB-C25*10	25	10	M6/M8	13	25	1.5
LRB-C25*15	25	15	M6/M8	17	33	2
LRB-C25*20	25	20	M6/M8	17	33	2
LRB-C25*25	25	25	M6/M8	17	33	2
LRB-C25*30	25	30	M6/M8	21	41	2.5
LRB-C30*15	30	15	M8	22	40	2
LRB-C30*20	30	20	M8	22	40	2
LRB-C30*25	30	25	M8	22	40	2

LRB-C Rubber Mounts

LIVA-EP
利瓦环保

LRB-C30*30	30	30	M8	28	50	2.5
LRB-C30*40	30	40	M8	28	50	2.5
LRB-C40*20	40	20	M8/M10	26	48	2
LRB-C40*25	40	25	M8/M10	26	48	2
LRB-C40*30	40	30	M8/M10	32	60	2.5
LRB-C40*40	40	40	M8/M10	38	72	3
LRB-C50*20	50	20	M10/M12	30	56	2
LRB-C50*25	50	25	M10/M12	30	56	2
LRB-C50*30	50	30	M10/M12	38	70	2.5
LRB-C50*35	50	35	M10/M12	38	70	2.5
LRB-C50*40	50	40	M10/M12	45	85	3
LRB-C50*45	50	45	M10/M12	45	85	3
LRB-C50*50	50	50	M10/M12	45	85	3
LRB-C60*30	60	30	M10/M12	60	110	2.5
LRB-C60*35	60	35	M10/M12	60	110	2.5
LRB-C60*40	60	40	M10/M12	60	110	2.5
LRB-C60*45	60	45	M10/M12	72	132	3
LRB-C60*50	60	50	M10/M12	72	132	3
LRB-C60*60	60	60	M10/M12	72	132	3
LRB-C70*30	70	30	M12/M16	110	200	2.5
LRB-C70*40	70	40	M12/M16	135	240	3
LRB-C70*50	70	50	M12/M16	135	240	3
LRB-C70*55	70	55	M12/M16	160	280	3.5
LRB-C70*65	70	65	M12/M16	160	280	3.5
LRB-C75*40	75	40	M12/M16	150	270	3
LRB-C75*45	75	45	M12/M16	150	270	3
LRB-C75*50	75	50	M12/M16	150	270	3
LRB-C75*55	75	55	M12/M16	175	315	3.5
LRB-C80*40	80	40	M12/M16	150	280	3
LRB-C80*50	80	50	M12/M16	175	280	3
LRB-C80*60	80	60	M12/M16	205	325	3.5
LRB-C80*80	80	80	M12/M16	235	370	4
LRB-C100*30	100	30	M16	190	350	2.5
LRB-C100*40	100	40	M16	230	420	3
LRB-C100*45	100	45	M16	230	420	3
LRB-C100*50	100	50	M16	230	420	3
LRB-C100*55	100	55	M16	270	490	3.5
LRB-C100*60	100	60	M16	310	560	4
LRB-C100*75	100	75	M16	310	560	4
LRB-C100*100	100	100	M16	390	700	5
LRB-C150*75	150	75	M16/M20	750	1400	5